

Bernel Road Park Disc Golf Course

GENERAL: Disc golf is played like ball golf using a flying disc. The object is to have fun playing the course from beginning to end in the fewest throws.

TEE OFF: Tee throws must be released from the tee pad.

LIE: The spot where the disc lands.

THROWING ORDER: After the tee-off, the player whose lie is the farthest from the basket throws first. The player with the lowest score on the previous hole is the first to tee-off on the next hole.

FAIRWAY THROWS: Fairway throws must be made with the foot closest to the basket on the lie. The other foot may be no closer to the basket than the lie. A run-up and follow through is permitted.

COMPLETION OF HOLE: A hole is complete when the disc is in the basket.

OUT OF BOUNDS: A throw that lands out of bounds must be played from the point where the disc went out (1 Throw Penalty).

COURSE COURTESY: Do not throw, until the players or park users are out of range!

For more information visit:
www.discgolf.com

This disc golf facility is maintained by:
Centre Region Parks and Recreation (CRPR)
(814) 231-3071 www.crpr.org

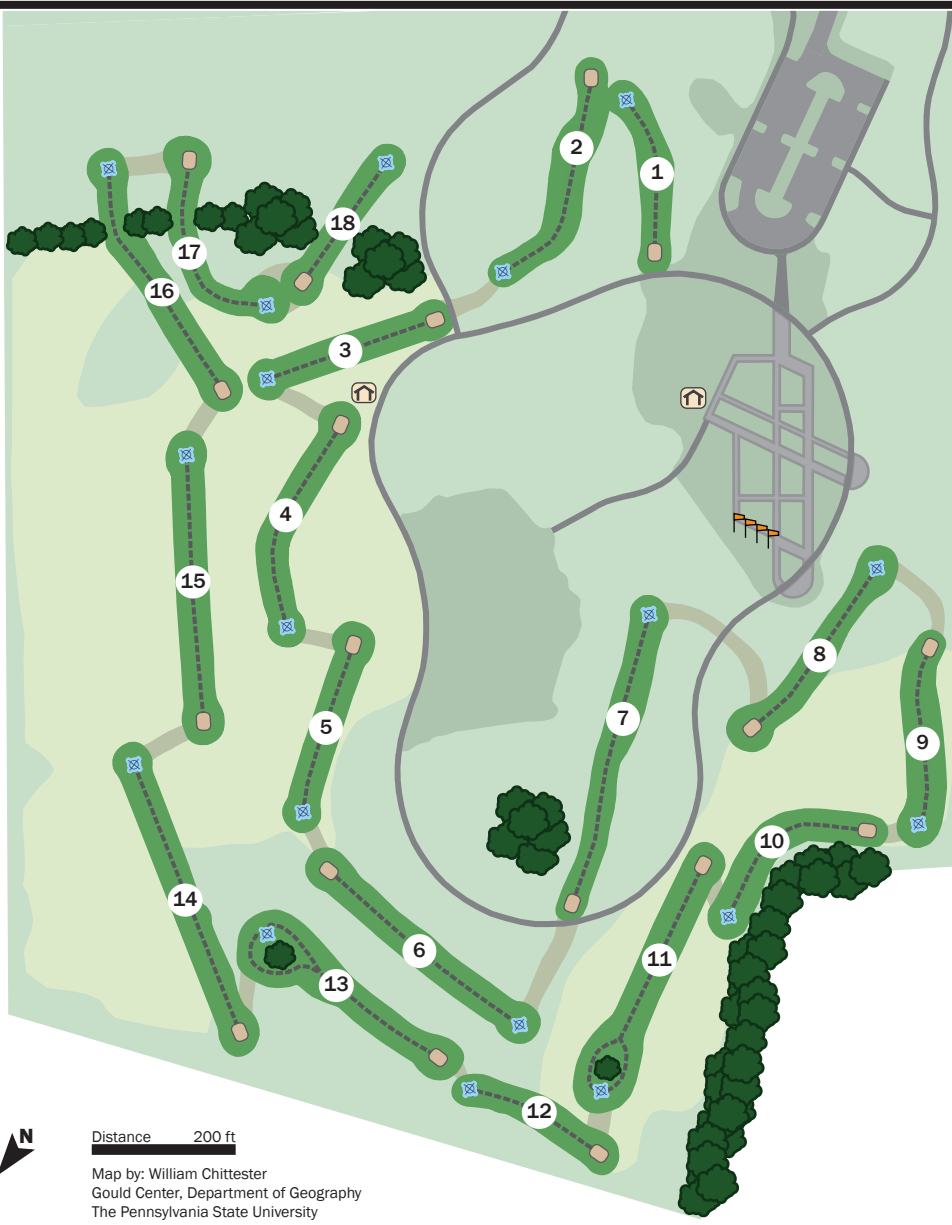

Hole	1	2	3	4	5	6	7	8	9	10	11	12	13	14	15	16	17	18	TOT	
Par	3	3	3	3	3	3	3	3	3	3	3	3	3	3	3	3	3	3	3	54
Distance (feet)	225	330	245	305	240	340	420	255	280	250	355	205	305	400	370	355	285	205	5370	